

VENUE HIRE AT THE SOUTH LONDON GALLERY

AWARD-WINNING
CONTEMPORARY ARCHITECTURE
MEETS VICTORIAN ELEGANCE IN
THIS GRADE II LISTED GALLERY IN
CAMBERWELL AND PECKHAM







ABOUT US

The South London Gallery (SLG) is a distinctive and elegant setting for a range of private functions, receptions and corporate events.

The gallery is one of London's leading venues for contemporary art and live art events, with an innovative education and outreach programme. Often described as a 'hidden gem', the SLG continues to offer tranquil respite from the hustle and bustle of Peckham Road.

Founded in 1891, the gallery's impressive main building was constructed from Portland stone and hand-made pressed bricks, much favoured by the Arts and Crafts tradition of the time. Many of the original architectural features remain and these are now complemented by the South London Gallery's award-winning extension. Designed by 6a architects, the contemporary architecture of the Clore Studio and Double Height Room provide the perfect setting for daytime and evening events.

In 2016, the gallery had the stunning addition of the Orozco Garden and Fox Reception. The new permanent garden was created over two years by the artist Gabriel Orozco with support from 6a architects and horticulturists at the Royal Botanic Gardens, Kew.

In September 2018, the SLG opened a second venue 120m down the road in the former Peckham Road Fire Station. The Grade II listed building dates from 1867 and now houses three floors of gallery space, and new options for venue hire in the Kitchen and Trusthouse Gallery.

The gallery welcomes over 190,000 visitors each year and is a registered charity. All income generated from venue hire directly supports the SLG's education, outreach and exhibition programmes.



VENUE HIRE

We have indoor and outdoor spaces with varying capacities, which can be hired individually or a combination that meets your needs.

1. Clore Studio
2. Orozco Garden
3. Fox Reception
4. Double Height Room & Fox Garden
5. Kitchen

Our adaptable spaces can be used for:

Canapé receptions

Parties

Private dinners

Marriage and civil partnership ceremonies in the Fox Reception or Clore Studio

Wedding receptions

Film and photography shoots

Conferences

Product launches

Presentations

Away-days

Meetings

Cooking demonstrations

Please Note

We are not able to hire out the venue for art exhibitions, fundraising activities or publicly promoted events.



MAIN BUILDING

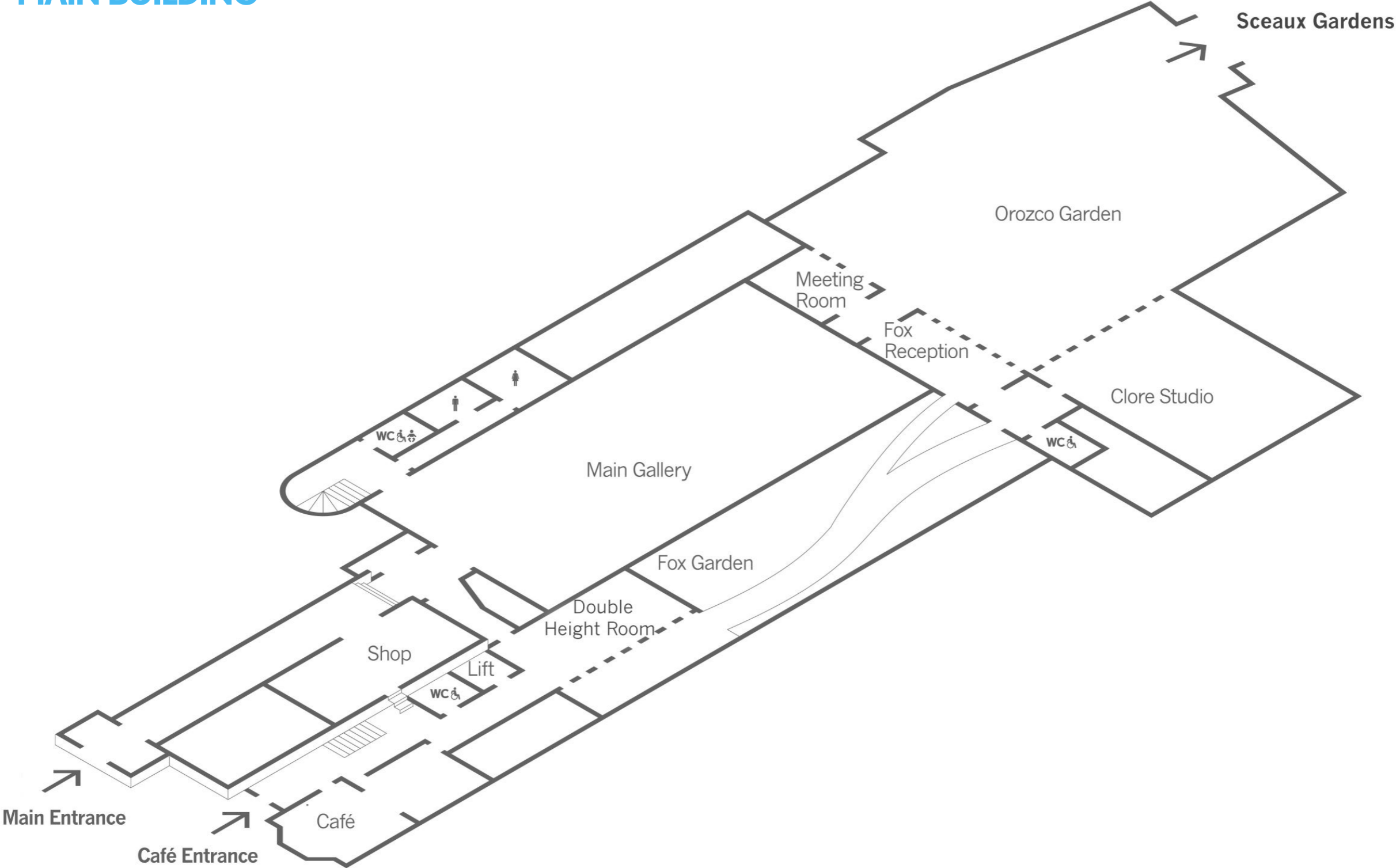

Peckham Road

FIRE STATION

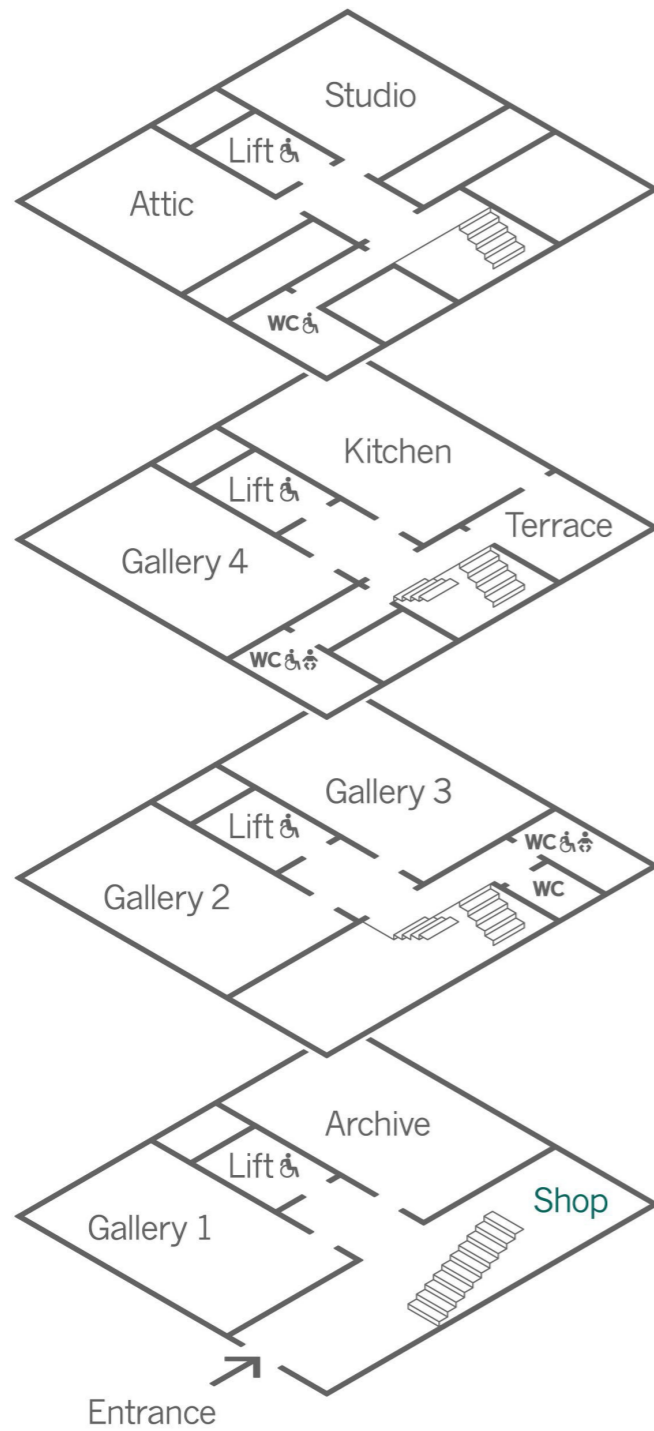

1. CLORE STUDIO

The Clore Studio was designed by 6a architects as part of the gallery's 2010 expansion, which received a New London Architecture Award in 2011. Situated behind the Main Building at the far end of the Fox Garden, the space is a contemporary and stylish setting for both daytime and evening events.

Illuminated from above by a skylight, the Clore Studio also benefits from fully pivoting doors which open out onto the gallery's spacious Orozco Garden.

Capacity

60 seated / 90 standing

Dimensions

8 x 10 x h. 3.7m

Facilities

Accessible WC

Coatrail

Use of up to 60 chairs and 10 trestle tables







PECKHAM

JO G	W	HELEN
ASHLEY	I	CATHY
DOROTHY	H	NELS
LISA U	E	WILL
WILAN		TOBI
BRVA		YENA
		JOHAN

Kenny



2. OROZCO GARDEN

The Orozco Garden was created in 2016 by the artist Gabriel Orozco, with support from 6a architects and horticulturists at the Royal Botanic Gardens, Kew.

Gabriel Orozco, who was born in Mexico and currently lives in Tokyo, is one of the leading artists of his generation. He has exhibited extensively internationally and periodically in London including a major mid-career retrospective at Tate Modern in 2011. For his first ever garden commission, he embraced the challenge of transforming a paved area at the back of the SLG's Main Building into a unique sculptural work.

The choice of materials was drawn from the language of the gallery's Victorian building and includes bricks from the rear facade. Playing on the idea of an urban ruin, the garden will gradually evolve with different grasses, low level creepers and fragrant plants.

Dimensions

16.5 x 15.5m

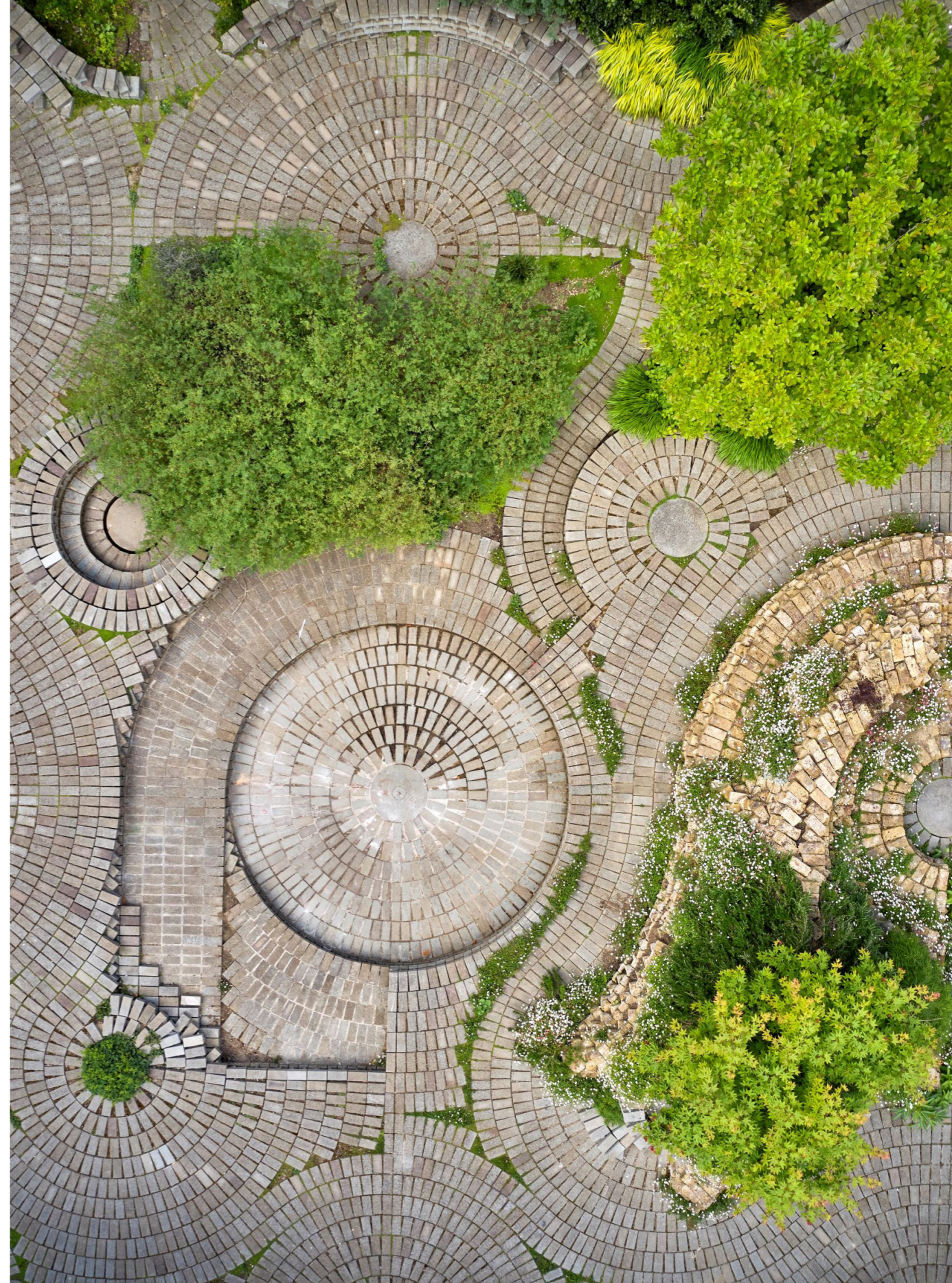







3. FOX RECEPTION

With glass doors looking out onto the Orozco Garden, the Fox Reception is a beautiful space and perfect for small groups, whether for a meeting, evening drinks or a private dinner.

This is a light, bright space and is decorated by an intricate architectural plan of the Orozco Garden on the wall.

Capacity

16 seated / 20 standing

Dimensions

3 x 5.6 x h.2.6m

Facilities

Accessible WC

Coatrail

Use of table and chairs



Orozco has designed this extraordinary garden on Gallery, with support from 6a architects and Royal Botanic Gardens Kew. The garden is open to weekend and used by invited groups during the week. A new entrance and a planted walkway for residents, housing estate, where the SLG has run art programmes for a number of years.

Those who have funded the South London Gallery's by Gabriel Orozco.

Gallery
 Action Fund
 for the Arts
 Community Foundation
 on
 Foundation
 er Southwark Council
 undation

rt Fund_ MARIAN GOODMAN GALLERY outset. COCHRANE



WELCOME TO THE SLG

The SLG comprises the South London Gallery Southwark Fire Station, two permanent gardens and Art Block, a space on Selsdon Gardens Estate for local children and young people.

Our year-round exhibitions programme showcases 10 international contemporary art, complemented by an extensive programme for people of all ages and free, regular family activities.

If you need more information about what to see and do, or talk about our activities, you can also pick up a Welcome to the SLG leaflet.

OPENING HOURS
 Gallery and Shop: 10am - 5pm, Tues - Sat
 Shop: 10am - 5pm, Tues - Sat
 Garden: 10am - 5pm, Tues - Sat

YOUR VISIT
 1. Welcome to the SLG leaflet
 2. Bookings and tickets
 3. Accessible parking
 4. Large print resources

SHOPPING
 The SLG shop is open from 10am to 5pm, Tues - Sat. It offers a range of books, cards, prints, and other items for sale.

ARCHIVE
 The SLG archive is a collection of historical documents, photographs, and other materials related to the gallery's history.

GARDENS
 The SLG gardens are a beautiful outdoor space for children and young people to play and learn.

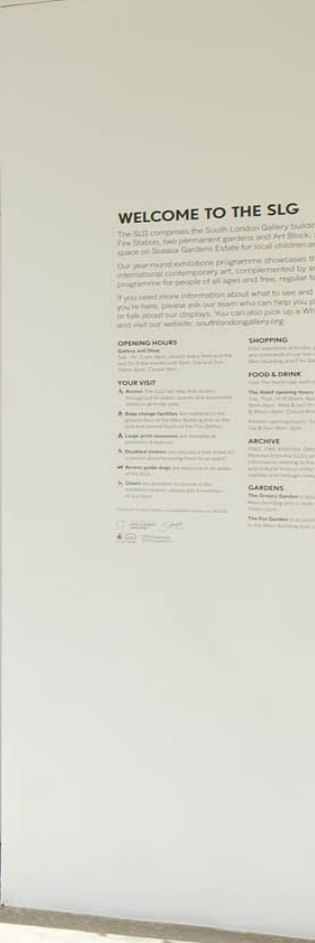

4. DOUBLE HEIGHT ROOM & FOX GARDEN

The Double Height Room is situated in SLG's cafe-restaurant on the ground floor of the gallery's 2010 extension in a restored Victorian house, and overlooks the beautiful Fox Garden. This light and airy contemporary space is adorned with artist Paul Morrison's striking gold leaf wall drawing *Asplenium*.

Capacity

28 seated / 40 standing

Dimensions

7.5 x 3.3 x h.6m

Facilities

Use of the room's furniture including a reclaimed oak table

Accessible WC

Access to the gallery's Fox Garden with additional seating

If you would like to hire this space, please contact Crane's Kitchen, info@craneskitchen.com





5. KITCHEN

The Kitchen is one of two new venue hire spaces in the Fire Station at 82 Peckham Road 120m from the Main Building. The space is perfect for a meeting, away day or a supper club. When the exhibition schedule permits, the nextdoor Trusthouse Gallery can also be hired for a drinks reception or seated dinner.

Capacity

10 seated / 20 standing

Dimensions

4.6 x 6.8 x h. 5.4m

Facilities

Accessible WC

View of the Fox Terrace

Standard domestic kitchen facilities





WEDDINGS

“We had a really fabulous day and couldn’t have asked for anything more.”

The SLG is licensed by Southwark Council for civil partnership and marriage ceremonies. If you are planning to hold your marriage or civil partnership ceremony at the South London Gallery you will need to liaise directly with Southwark Registry Office to book a registrar to conduct the ceremony.

You can contact them on 020 7525 7651 or email registrars@southwark.gov.uk.



FURTHER INFORMATION

Availability and Timings

The Clore Studio, Fox Reception and Orozco Garden can be hired, subject to availability, at any time during the week, 9am - 11pm, and on weekend evenings, 6pm – 11pm.

The Fire Station Kitchen can be hired daily, 9am - 11pm.

The Trusthouse Gallery can be hired daily, 9am - 11pm, when there are no exhibitions in the space.

The Double Height Room, and adjoining Fox Garden can be booked directly with the cafe-restaurant in the evening at times when the gallery is closed, and can occasionally be booked in conjunction with the Clore Studio and/or Fox Reception for early evening drinks (up to 40 guests).

The minimum booking is for a half-day or evening. When making your booking please allow for any time you may need to set up prior to the start of your event and to clear the space afterwards as any additional services or use of the rooms will be charged.

Music

If you are booking the Clore Studio you can have access to the room's built-in sound system to which you can connect up your laptop, MP3 player or iPod to play music. The SLG's sound system

can reach a maximum of 63 amps and we are happy to provide guidance about whether hiring in a PA system may be appropriate for your plans. Please note that as the main building is located in a residential area we have to be mindful of our neighbours and require the pivoting doors to the Clore Studio to be closed from 9.30pm onwards with no music in the gardens after this time. Access to the garden after 9.30pm is via the Clore Studio's standard door.

Access

The SLG has step-free access throughout its gallery spaces, hire spaces, cafe and gardens.

The Orozco Garden is wheelchair accessible on the outer path, but please note the central path features some planting areas which can create gaps of up to 22cm across in the pathway, which reduces its width to approximately 66cm wide. The Orozco Garden paths have paving stones with a minimum gap of 5mm between them, and a maximum gap of 30mm between them. Please note the Orozco Garden contains different levels and structures within it, including built-in seating areas.

For further information about accessibility at the South London Gallery, please contact us.

Deliveries

The SLG is not able to store items prior to or following your event. Please allow for deliveries and collection within the period of your event booking. There is a loading bay on Peckham Road outside the Main Gallery which permits deliveries, 10am-1pm. Parking for the Fire Station can be found on neighbouring residential streets. Please discuss arrangements for deliveries and pickups at the Fire Station

Support Staff

The SLG offers a friendly, welcoming and reliable team of staff to assist your event planning, as well as during your event.

Tours

Tours of the gallery's exhibitions can be arranged to enhance and enrich your event.

Smoking

The SLG's buildings and garden are non-smoking areas. Smoking is allowed on the forecourts at the front of the Main Gallery and Fire Station.

Candles

Candles are not permitted at the SLG.



PRICING

	Half Day (4 Hours) 4 hours within 9am-6pm	Full Day (8 hours) 9am-5pm or 10am-6pm
Clore Studio, Fox Reception & Orozco Garden	£1,000 +VAT	£1,800 +VAT
Fox Reception & Orozco Garden	£500 +VAT	£800 +VAT
Clore Studio (Meeting)	£400 +VAT	£800 +VAT
Fox Reception (Meeting)	£200 +VAT	£400 +VAT
Kitchen	£200 +VAT	£400 +VAT
Trusthouse Gallery	£200 +VAT	£400 +VAT
Kitchen and Trusthouse Gallery	£300 +VAT	£600 +VAT

Payment

50% of the hire fee and a 25% damages fee is required within one week of signing the Terms and Conditions, and the remaining 50% is due at least 10 working days prior to your event.

Discount for Local Businesses and Charities

We are pleased to offer a discount on venue hire to local businesses and registered charities within one mile of the SLG. Please enquire for more details.

Evening Only 6-11pm	Afternoon & Evening 1-11pm	Full Day & Evening 9am-11pm
£2,100 +VAT	£2,800 +VAT	£3,750 +VAT
N/A	N/A	N/A
N/A	N/A	N/A
N/A	N/A	N/A
£600 +VAT	£800 +VAT	£1,100 +VAT
£600 +VAT	£800 +VAT	£1,100 +VAT
£900 +VAT	£1,200 +VAT	£1,650 +VAT

Timings

Decorating and cleanup must be done by the hirers within the booking period. The caterers will put out chairs and tables if required. All guests are required to leave by 11:30pm.

Insurance

If you are a business hiring a space at the SLG, you will need to provide us with evidence of public liability insurance with a cover of not less than £5,000,000.

CONTACT

Please contact us to check availability and confirm the quotation for your event including any technical requirements you have. Once this has been agreed you will be sent a Booking Form together with Terms and Conditions for Hire.

If you have any questions about timings or the format of your booking, we are happy to advise you on these matters to ensure your event is a great success.

Venue Enquiries

For further information or to arrange a tour, please contact the South London Gallery:

venuehire@southlondongallery.org

020 7703 6120

www.southlondongallery.org/venuehire

HISTORY OF THE SLG

The South London Gallery opened in 1891 and was founded as a “gallery for the people of south London” which would be free for all and open on Sundays. The SLG has earned an international reputation for its pioneering programme of contemporary art exhibitions, live art events and education projects for children, young people and adults. The exhibition programme profiles the work of established international figures such as Dara Birnbaum, Ellen Gallagher, Michael Landy, Rivane Neuenschwander, Pae White and Lawrence Weiner; as well as that by younger and mid-career artists such as Alice Channer, Ryan Gander, Oscar Murillo, Eva Rothschild and George Shaw. Group shows bring together works by established and lesser-known British and international artists gallery’s live art, talks and film programme has featured presentations by Charles Atlas, Tony Conrad, Nathaniel Mellors, Shana Moulton, Kelly Nipper, OMSK, Gail Pickering, Lucy Raven, Marina Rosenfeld and Gisele Vienne.

Exhibitions are free, as well as many of the SLG’s events. The gallery is open to the public from Tuesday until Friday, 11am–6pm, and until 9pm on Wednesday evenings and the last Friday of the month.

The South London Gallery is a registered charity, number 312160.

LOCATION AND DIRECTIONS

The Main Building and Fire Station are situated 120 metres from each other, on either side of Peckham Road.

Underground

Oval then take bus 36 or 436; Vauxhall then take bus 36 or 436 from bus stop C; Elephant & Castle then bus 171 or 12 from bus stop D or R, or 343 from bus stop G or R

Bus Routes

12, 36, 171, 343, 345 and 436

Train/Overground Peckham Rye is just over half a mile from the Main Building

Car

There are no parking facilities at the SLG, pay and display parking is available on the surrounding streets.

There is a parking bay directly in front of the gallery for blue badge holders for up to three hours between 10am and 1pm. This cannot be reserved in advance.

SOUTH LONDON GALLERY

Main Gallery

65–67 Peckham Road London SE5 8UH

Fire Station

82 Peckham Road London SE15 5LQ

T: +44 (0)20 7703 6120

www.southlondongallery.org/venuehire

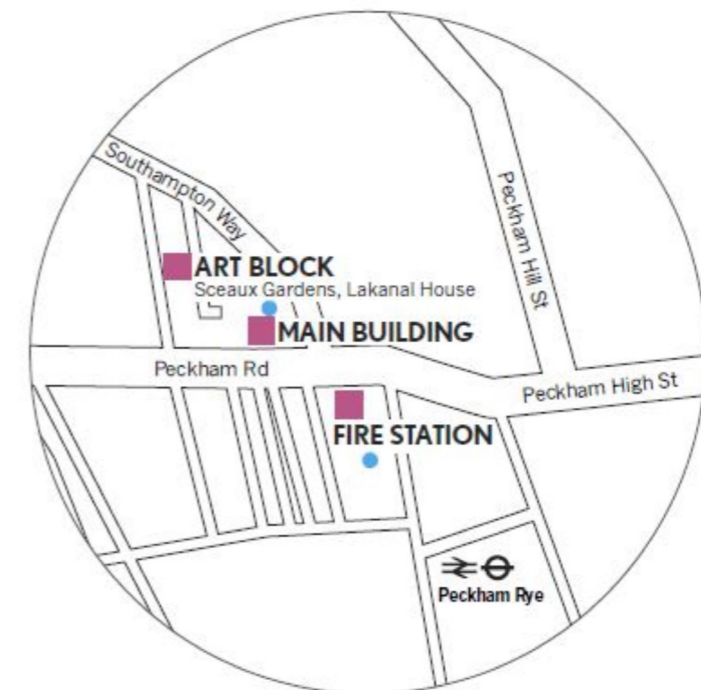

● **Public art** For more information and directions ask a member of staff

CREDITS

Photography:

Kristel Baesaar

Amy Beasley

Max Colson

Johan Dehlin

Katie Haines

Sam Holden

David Potter

Andy Stagg

Edmund Sumner

Luke Tchalenko

In the Right Light

Remain in Light

Enara Photography

Cake Image:

Cake: Neighbourhood Bakes

Floral Design, Concept and Styling: Boom Blooms

Concrete Plinth: Smith and Goat

“We had a fantastic day. Everything worked out really well, it even stopped raining and the sun came out! ... The staff were brilliant, helpful and very kind. The venue worked perfectly, the café team excelled and everyone agreed that it was a great success.”

“Thanks for making our special day so very special indeed. It was the perfect venue for us.”



